

\$79,900 - Block 3 Lot 3 Joppi Court, Bryan

MLS® #24017208

\$79,900

Bedroom, Bathroom,
Land on 0.23 Acres

Pinemont, Bryan, TX

Come pick your lot and build your dream home! This new Pinemont Subdivision is being developed behind Branch Elementary School and is nestled between two established neighborhoods, Edgewater & Autumn Ridge. Pinemont has sidewalks and a nearby park. Located off of W Villa Maria Road and Autumn Lake Drive, Pinemont Subdivision combines the tranquility of suburban living with easy access to the city's amenities. These oversized cul-de-sac lots are within a mile radius of Brazos Christian, Kingsgate Christian, and Branch Elementary, and just over two miles from Texas A&M University, Texas A&M School of Medicine, and RELLIS campus. These lots offer quick access to Rudder's Landing Retail Center, featuring a variety of retailers: Walmart, Chick-fil-A, Dutch Bros™s, Subway, and Domino's. Just a short drive to the evolving Bryan Midtown Park, including Legends Event Center and Top Golf. 11 total available lots and all remaining lots are oversized cul-de-sacs. Ranger & Avonley Homes are building on the sold lots. City of Bryan Utilities and Bryan Schools.

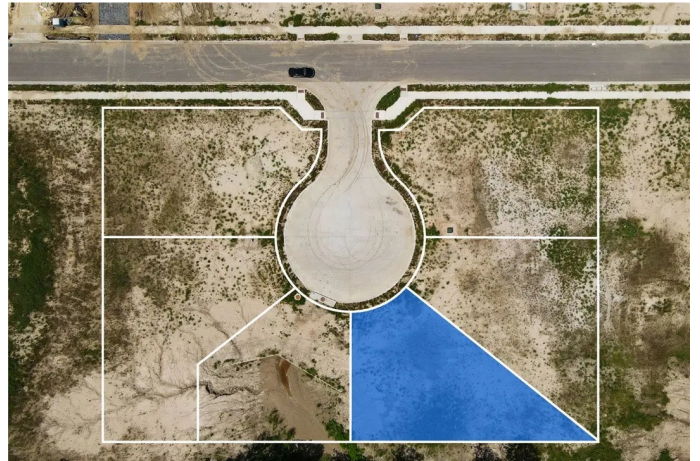

Essential Information

MLS® #	24017208
Price	\$79,900
Acres	0.23
Type	Land

Sub-Type	Unimproved Land
Status	Active

Community Information

Address	Block 3 Lot 3 Joppi Court
Area	B10
Subdivision	Pinemont
City	Bryan
County	Brazos
State	TX
Zip Code	77807

Exterior

Lot Description	Open Space
-----------------	------------

School Information

District	Bryan
----------	-------

Additional Information

Days on Market	315
----------------	-----

Listing Details

Listing Agent	Kamron Motter
Listing Office	Riverstone Companies, LLC

The information being provided is for consumers' personal, non-commercial use and may not be used for any purpose other than to identify prospective properties consumers may be interested in purchasing. The data is deemed reliable but is not guaranteed accurate by the MLS. Listing information is provided by Bryan-College Station Regional MLS.